

SALES DRAWING

SALES DRAWING

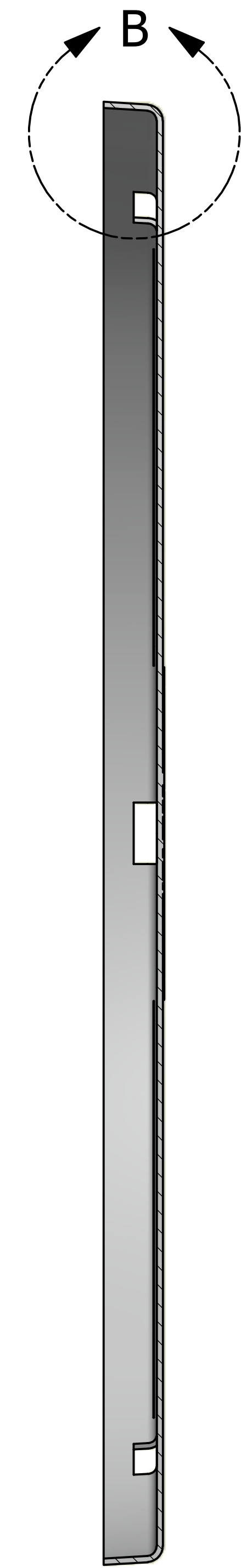

SECTION A-A

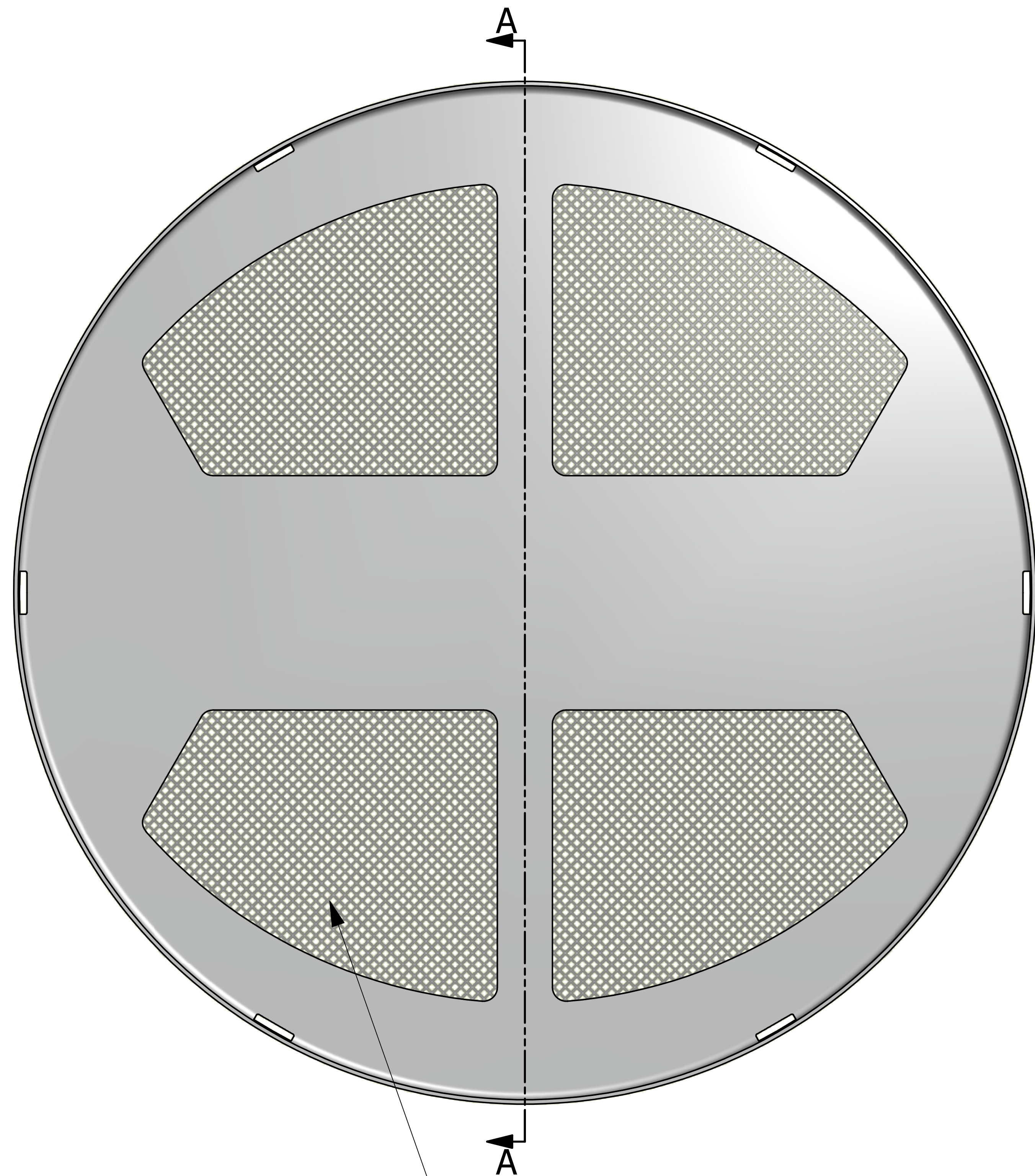
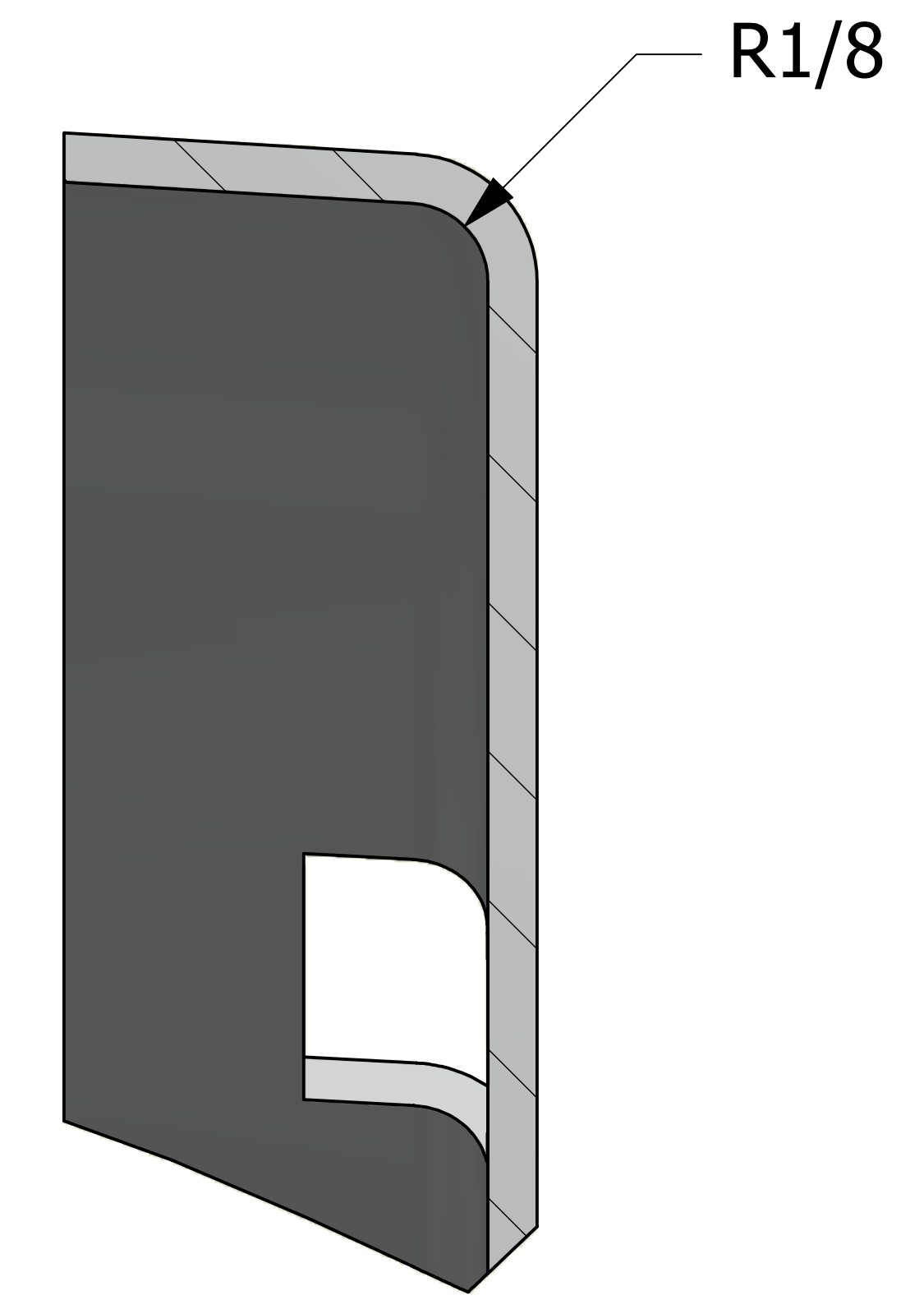

DETAIL B
SCALE 4 : 1

SCREEN MATERIAL TO BE WHITE POLYESTER
FIBER PLAIN WEAVE, 4.1 OZ/YD2 MULTIFILAMENT
18 X 15 THREAD, 150 DENIER, #5 FINISH.

SALCO PRODUCTS
630-783-2570

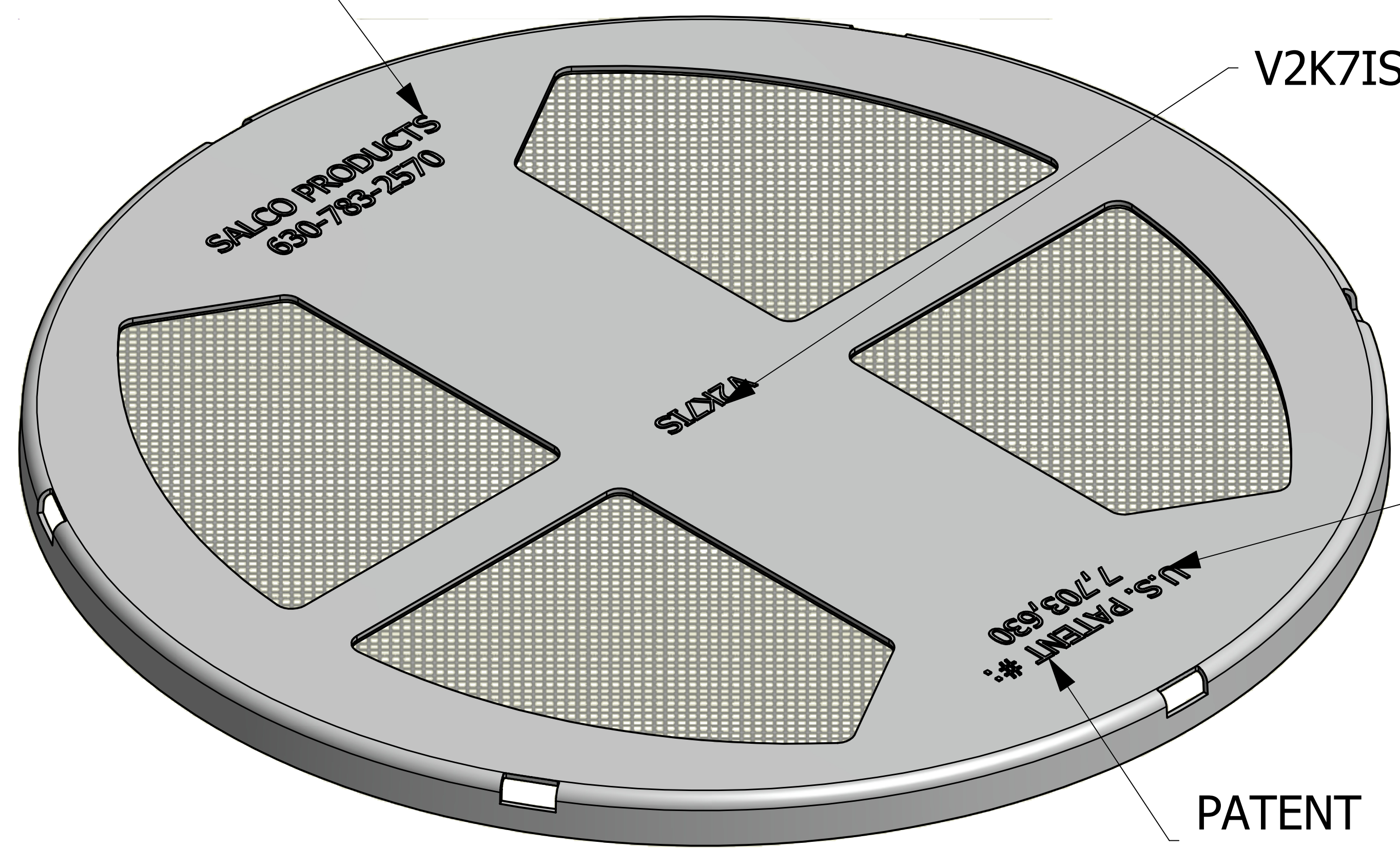

ISOMETRIC VIEW

CAVITY NUMBER LOCATED
IN THIS AREA ON
UNDERSIDE OF PART

PATENT
PENDING

NOTE:
TEXT TO BE 3/8" TALL
RAISED .016"

REV	BY	DATE	DESCRIPTION
E	CHL	5-24-13	REMOVED CUTOUT 6X.22, CHANGED DIMS .38, .25 TO .37 & .24, ADDED DIM 3.5°
D	CHL	4-24-13	REMOVED DIMS .38, 1 1/2, 3 & .22 W/RIBS
C	CHL	7-27-12	MATERIAL WAS PRO-FAX PD702 PP
B	AJB	3-10-10	RELOCATED PART NUMBER FROM EDGE.
A	CHL	2-11-10	NEW PART ADDED TO SYSTEM

UNLESS OTHERWISE SPECIFIED DIMENSIONAL TOLERANCES	DRAWN BY:	PJG
FRACTIONAL: ±1/16	CHECKED BY:	
X.XX: ±.03	PROTOTYPE BY:	PJG
X.XX: ±.015	PROTOTYPE DATE:	4/19/2006
ANGULAR: ±1°	APPROVED FOR PRODUCTION BY:	PJG
THIRD ANGLE PROJECTION	PRODUCTION DATE:	2/11/2010

SALCO PRODUCTS, INC.		
PART NAME: V2K7IS		
MATERIAL: POLYPROPYLENE		
PROJECT #: 050316	SHEET #: 1 OF 1	SCALE: 3:4
DRAWING #: E21920	PART #: V2K7IS	